

Smart emergency light IP65

MaxPro Safe 65

User manual

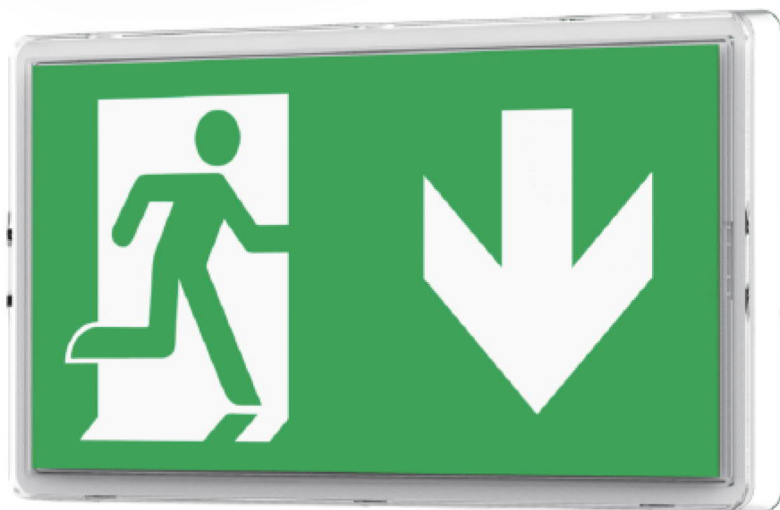

MAXPRO®
maxprolight.com



1 Security related information

- Installation should be carried out in accordance with the latest edition of the I.E.E. Wiring regulations and taking into consideration the latest building regulations.
- Ensure that all electrical connections are tight with no loose strands, including factory made connections.
- Ensure there is adequate free air circulation of at least 100mm around the luminaire. It is the installer's responsibility to consider fire risk and take appropriate precautions.
- A separate enclosure may be required if this unit is to be used in dusty and wet environments.

Q.C. date label, installation in an improper working environment or installation not according to the current edition of the I.E.E. Wiring Regulations . The guarantee is also invalidated if the luminaire has been I.R. tested. Should this product fail during the guarantee period it will be replaced free of charge, subject to correct installation and return of the faulty unit. We do not accept responsibility for any installation costs associated with the replacement of this product. Your statutory rights are not affected. We reserve the right to alter specifications without prior notice.

2 Packing list



Luminaire *1

Remote controller*1
optional



Installation pack



Recess installation pack



The Legend *1 set



User manual *1



Hanging safety sign
Optional

3 Basic Parameters

Model	Maxpro Safe 65-3H Self-test & remote Test series		
EM Working mode	Non-maintained and Maintained in one design		
Material	100% polycarbonate		
LED Chips	15pcs 2835		
Input Voltage	AC200-240V 50/60HZ		
Total Input Power	Non-maintained mode: 1.5W / Maintained mode:3.0W		
Luminous Flux In AC mode	Non-maintained mode: 0LM / Maintained mode: 100LM		
Luminous Flux In EM mode	230 Lm		
Color Rendering Index	>80		
CCT	4000K		
Battery pack	Li(CoNiMn)O2 3.7V 2.6A		
Degree of prtction	IP65		
Power factor	0.5		
Warm up time	<1S		
LED lifespan	50,000 hrs		
Bean angle	120°		
Standard	60598-2-22:2021 & IEC 61347-2-7		
Standard of Pictogram	ISO7010 & ISO3864 - 1/4		
TEST			Manual + self + remote test
Charging indicator	Green		
Faulty indicator			RED
Guarantee	5 Years (Battery 2 years)		

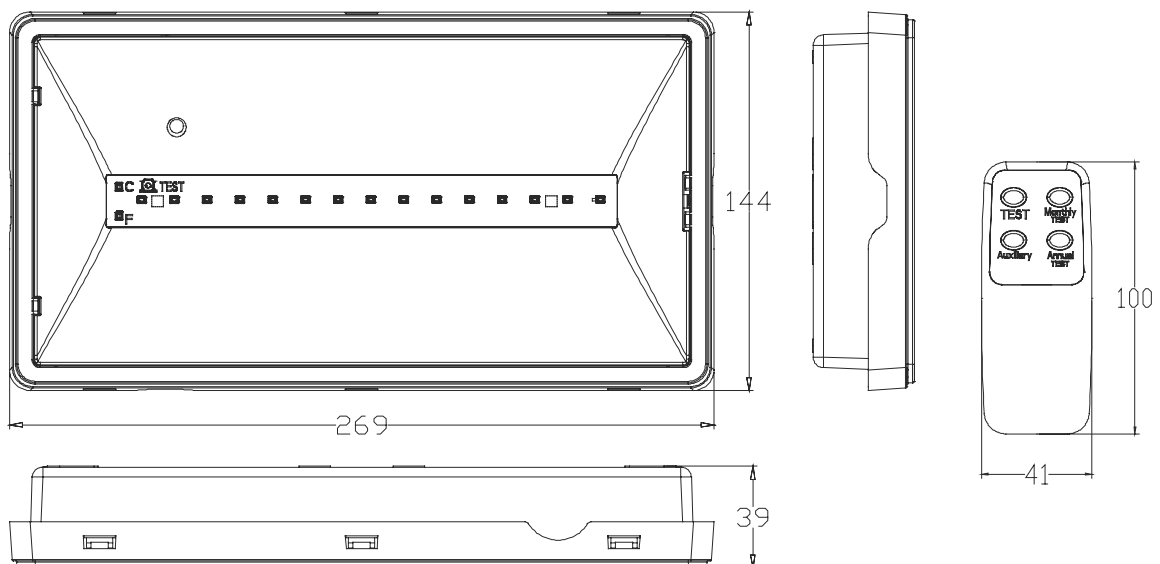

4 General Construction

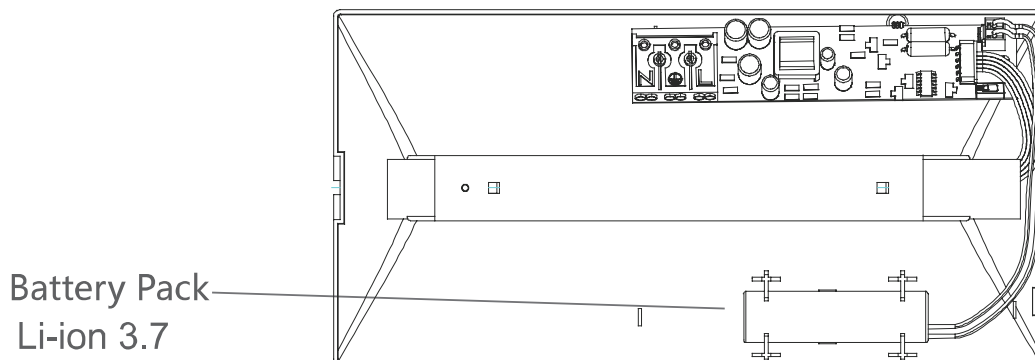
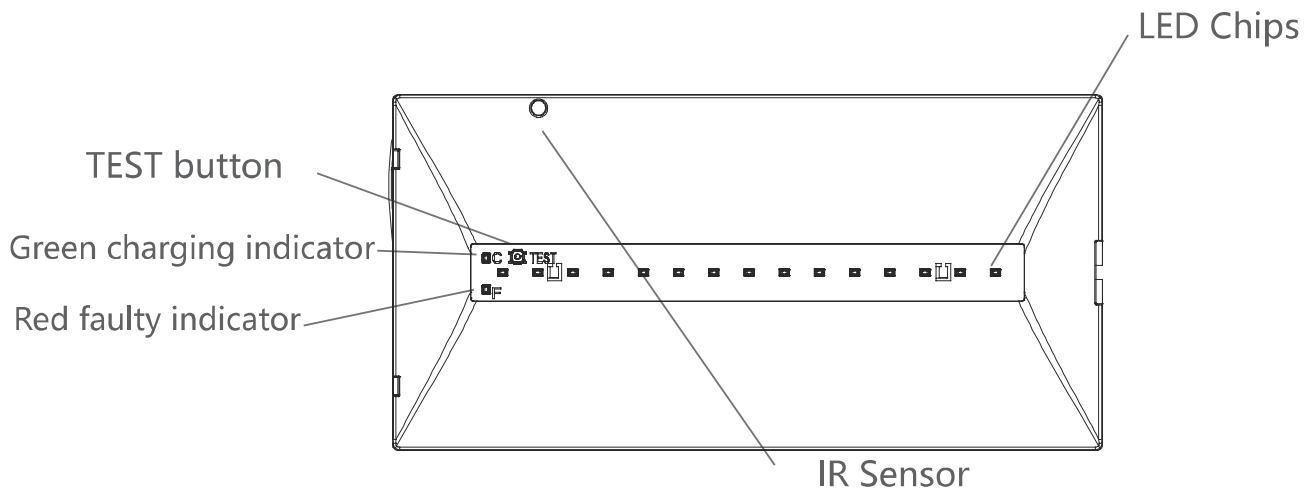
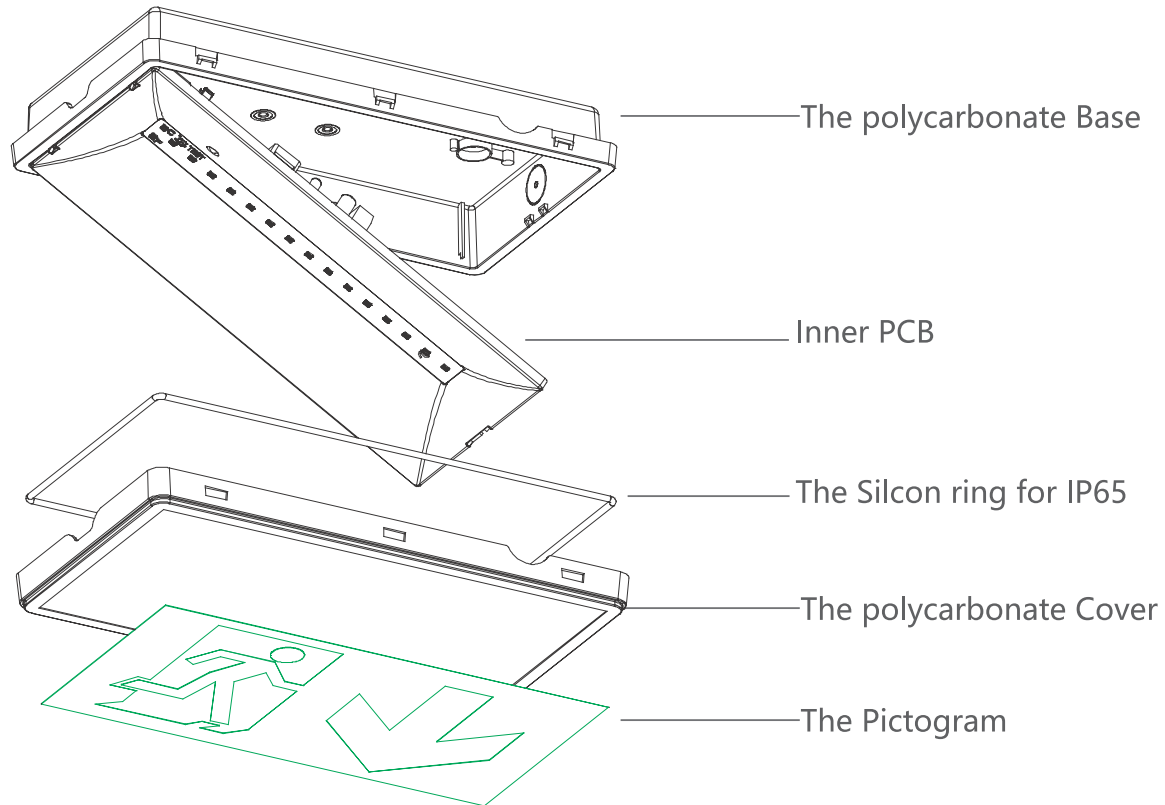

5 Self & remote test system

5.1 Testing (If no failure)

5.1.1. Manual function test.

Active the ④ test button.
or press "TEST" switch on controller.

- a) The ② Charging indicator OFF;
- b) The Emergency function ON;
- c) The test will cut off the mains.

5.1.2 Monthly test.

Active the ④ test button for 5 second;
or press the "Monthly TEST" switch on controller;
or the lamp installed every 30 days.

- a) The ② Charging indicator will flash in 1Hz for 128s;
- b) The Emergency function ON;
- c) The test finished and back to standby mode.

5.1.3 Annual test.

Active the ④ test button for 7 second;
or press the "Annual TEST" switch on controller;
or the lamp installed every 180 days.

- a) The ② Charging indicator will flash in 2Hz for 3hours;
- b) The charging will be cut off & emergency function ON 3hours;
- c) The lamp back to standby mode after test.

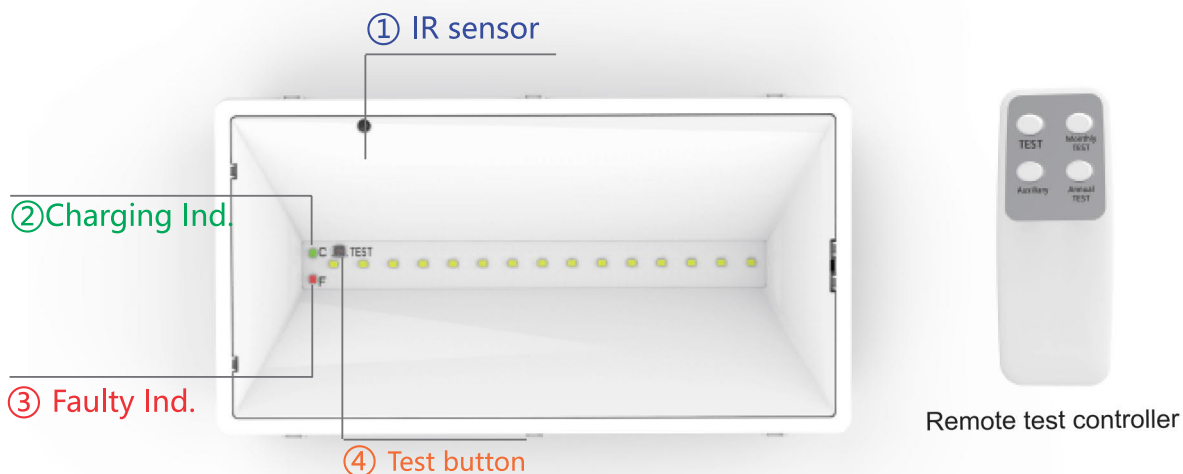

5.2 Testing (If any failure)

5.2.1 Battery failure:

Monitored Every hour. The

③ faulty indicator

will flash in 1 Hz if the

5.2.2 LED load failure:

If press test button, or the luminary self-monthly test. The

③ faulty indicator

will flash in 2 Hz if LED load failure.

5.2.3 Duration failure:











Only in Annual self-test. The Battery can not last 3 hours

③ faulty indicator

will turn on constantly if the

6 Emergency control logic

The emergency function control logic

Operation	Charging indicator (Green)		Faulty Indicator (RED)		Emergency LED Maintained mode		Emergency LED Non-Maintained mode	
	1 Second	1 Second	1 Second	1 Second	1 Second	1 Second	1 Second	1 Second
Normal charging	Constantly on		OFF		Constantly on		OFF	
Normal AC Failure	OFF		OFF		Constantly on		Constantly on	
Manual test	OFF		OFF		Constantly on		Constantly on	
Monthly self-test			OFF		Constantly on		Constantly on	
Annual self-test					OFF		Constantly on	
Battery circuit failure	OFF				Constantly on		OFF	
Light source failure	Constantly on				OFF		OFF	
Duration test failure	Constantly on		Constantly on		Constantly on		OFF	

7 Maintained and non-maintained changeover

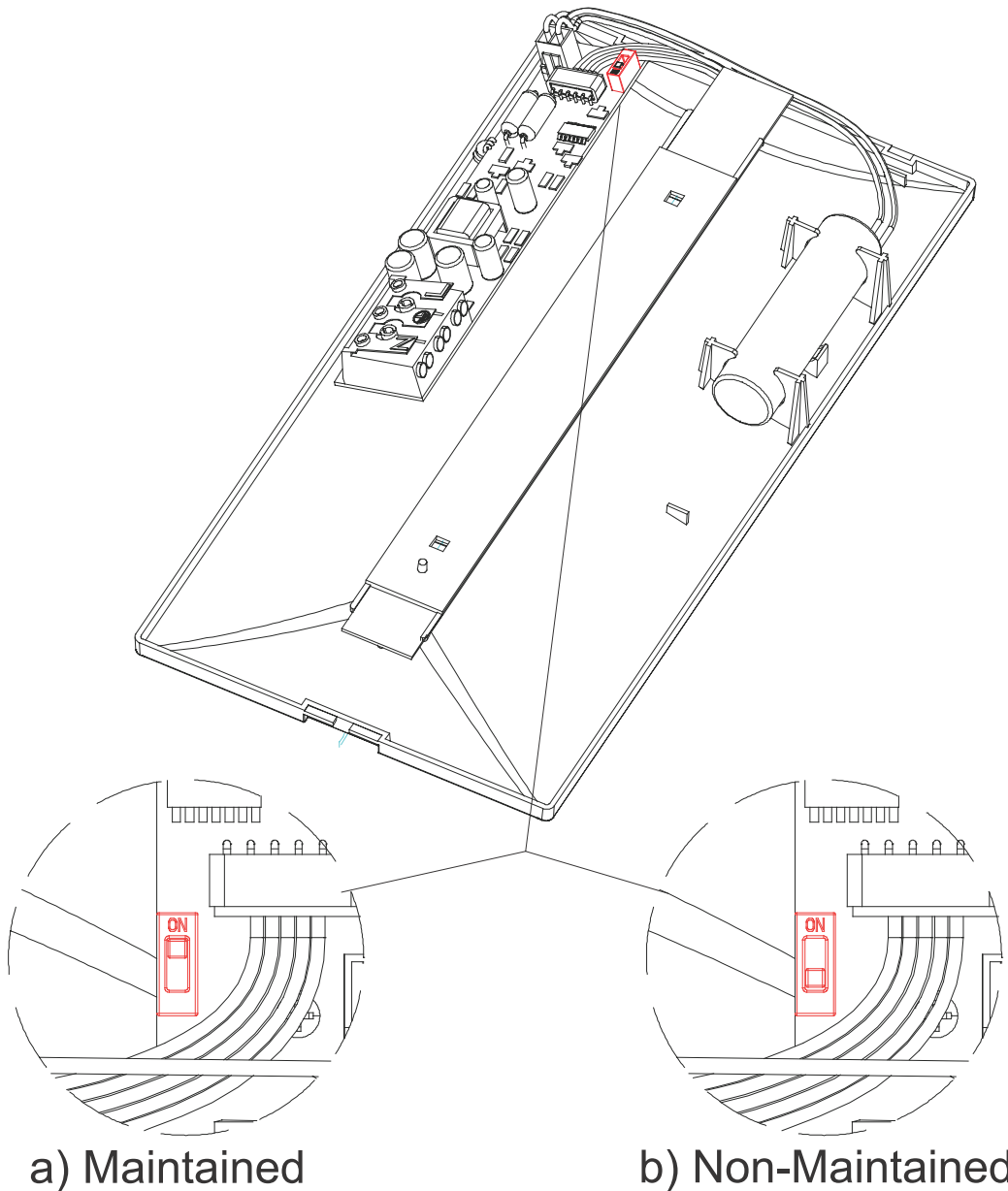

a) Maintained

b) Non-Maintained

Maintained & Non-maintained work mode

The Maxpro Safe 65 series can work both in maintained and non-maintained mode.



a) Dip switch ON. It works in maintained mode;



b) Or it works in non-maintained mode.

8 Test before installation

ADDITIONAL INFORMATION - COMPONENT REPLACEMENT

- The luminaire contains no user replaceable components other than the battery pack contained in emergency versions.
- The battery has a 4 year service life provided it is operated and maintained by regular testing, as detailed in this User manual. Failure to maintain or change the battery may result in reduced duration in emergency mode.

Emergency function test before installation

1. Connect the AC cable according to the Dia 1.
Keep battery plugged on.
Set Maintained /non-maintained mode according Page 7.
2. AC Supply on
The Charging Indicator On, The faulty Indicator Off
The EM LED On if set maintained mode in step1 .
OFF if set Non-maintained mode in step1 .
3. Press the test button, The charging indicator off, and EM LED on.
4. Unplugged the battery,
Charging indicator OFF,
Faulty indicator flash in 1Hz.

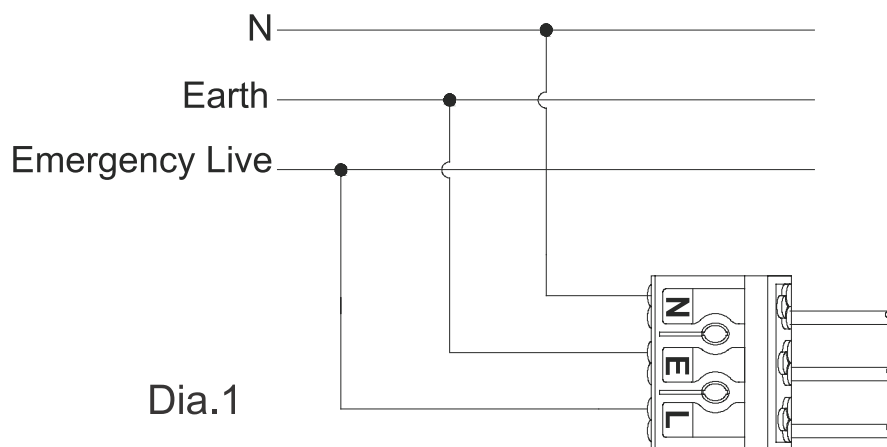

9 Installation guide



Caution

1. All OTC emergency devices are designed for projects. Only qualified electrician can install or maintain them.
2. The mains have to be off during the installation or maintenance.

9.1 Ceiling / wall mounting

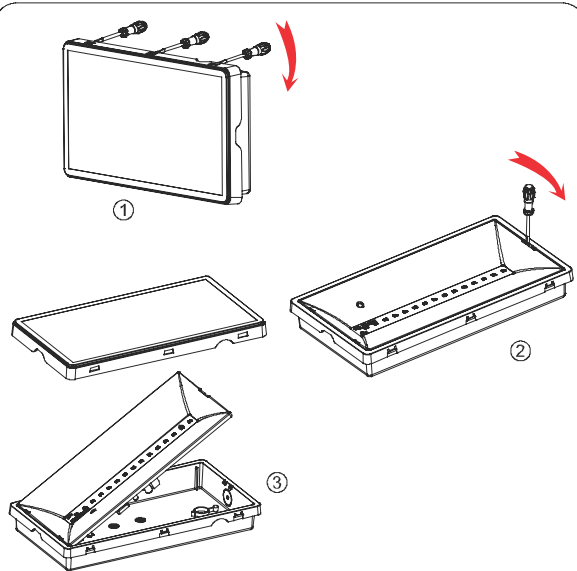

1. Open the diffuser by screw driver
2. Open the middle .

Step 1

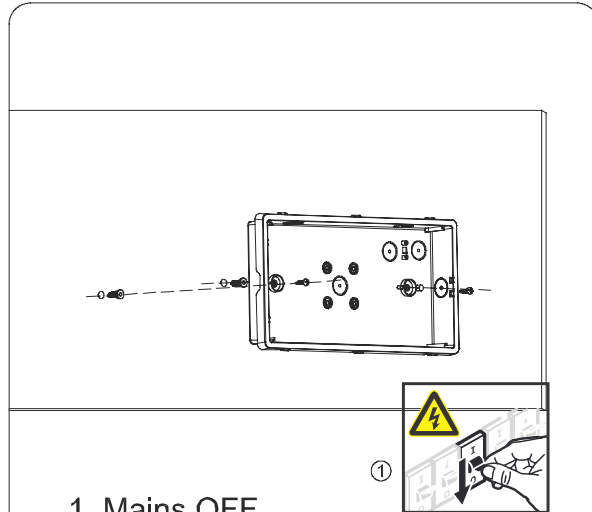

1. Mains OFF
2. Chose right cable entrance hole.
3. Install the base on the wall .

Step 2

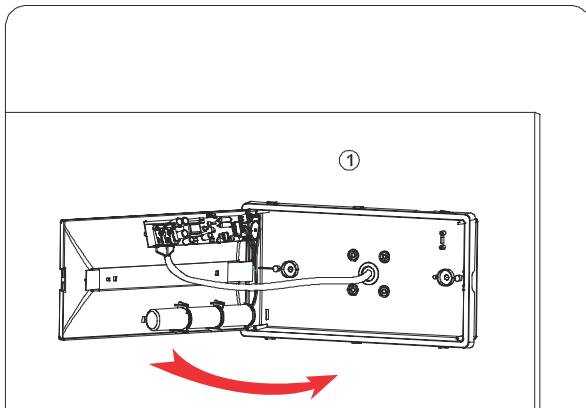

1. Wire the AC powersupply
2. Set working mode.
3. Battery Plug in.

Step 3

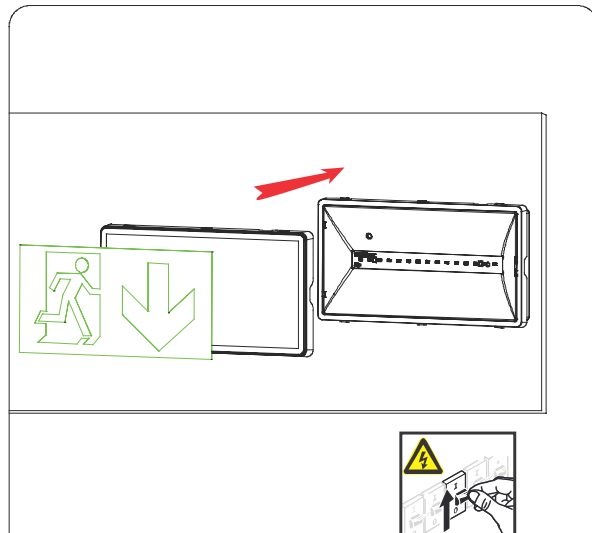

1. Install the cover
2. Chose right Pictogram.
3. AC supply on and test it again.

Step 4

9.2 Recessed mounting

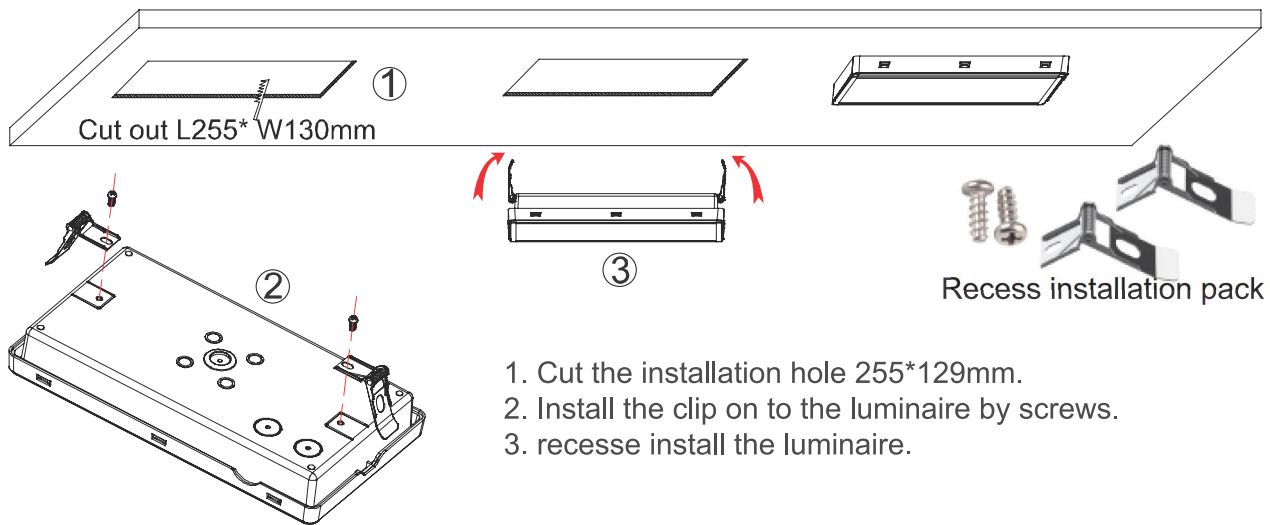

9.3 Install as exit sign

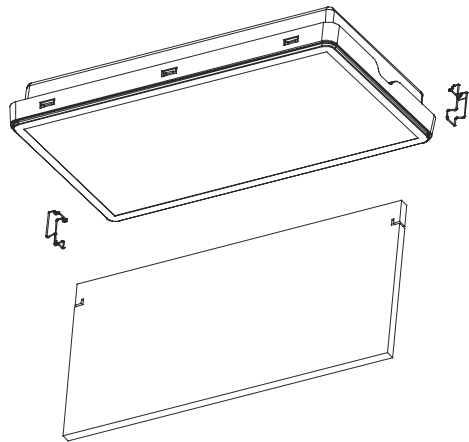

Hanging safety sign
Accessories

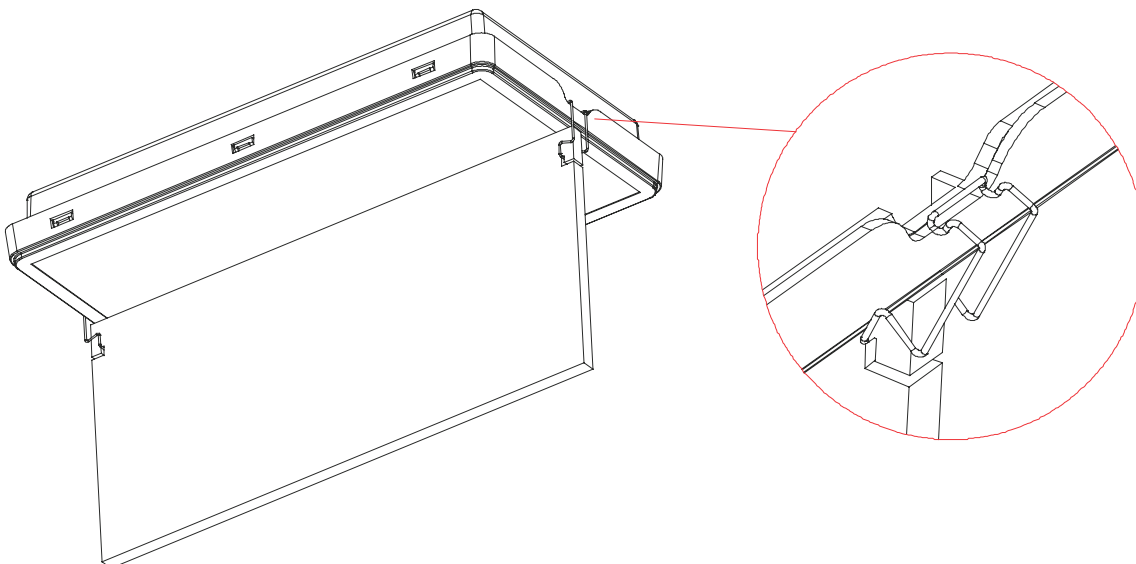

Luminaire emergency inspection record

month	Test	First Year		Second Year		Third Year		Fourth Year		Fifth Year	
		Signed	Date	Signed	Date	Signed	Date	Signed	Date	Signed	Date
1	Functional										
2	Functional										
3	Functional										
4	Functional										
5	Functional										
6	1 hour										
7	Functional										
8	Functional										
9	Functional										
10	Functional										
11	Functional										
12	3 hours										

Installed By:

.....

Installed Date:

.....

Luminaire NO.:

.....

Luminaire Location:

.....

Contact details:

.....